

MT

PN



RESPECT • SUPPORT • INSPIRE



MT™ TOOLING SYSTEM

FOR HIGH PERFORMANCE PRESSES

MT™ TOOLING

HIGH PERFORMANCE MT TOOLING DESIGNED FOR IMPROVED PRODUCTIVITY

- High Speed Steel punches for superior edge wear resistance
- Near polished punch flanks with 1/4 degree back taper eliminates galling
- Superior compatibility with Mate manufactured multi tool assemblies
- Close stripper to punch clearance for superior alignment
- Highly wear resistant die steel for exceptional strength
- Slug Free® Die geometry eliminates slug pulling for improved hole quality
- Maxima® coating available on punches for extended tool life



MT 8MM

Maximum 0.315(8.00)
diameter/diagonal



Punch

Round **PAFY0A**
Shape **PAFY_A**



Stripper

Round **S6FY0A**
Shape **S6FY_A**



Slug Free Die

Round **DOFY0A**
Shape **DOFY_A**

Shims

20 Each: **MSFY**
0.004(0.10)
0.006(0.15)
0.008(0.20)
0.024(0.61)

MT 16MM

Maximum 0.630(16.00)
diameter/diagonal

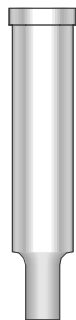

Punch

Round **PAFX0A**
Shape **PAFX_A**



Stripper

Round **S6FX0A**
Shape **S6FX_A**



Slug Free Die

Round **DOFX0A**
Shape **DOFX_A**

Shims

10 Each: **MSFX**
0.004(0.10)
0.006(0.15)
0.008(0.20)
0.024(0.61)

MT 24MM

Maximum 0.945(24.00)
diameter/diagonal

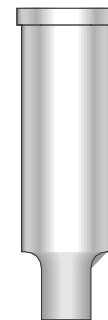

Punch

Round **PAFZ0A**
Shape **PAFZ_A**



Stripper

Round **S6FZ0A**
Shape **S6FZ_A**



Slug Free Die

Round **DOFZ0A**
Shape **DOFZ_A**

Shims

8 Each: **MSFZO**
0.004(0.10)
0.006(0.15)
0.008(0.20)
0.024(0.61)

MT TOOLING STRIPPER AND DIE PULLER TOOLS



- NMOYK** MT 8mm Stripper and Die Puller Set— (includes stripper and die puller, magnet pen and retrieving tool)
- NMOXK** MT 16mm Stripper and Die Puller Set— (includes stripper and die puller and magnet pen)
- NMOZK** MT 24mm Stripper and Die Puller Set— (includes stripper and die puller and magnet pen)
- NMOOK** Complete Kit for MT Tooling— (includes 8mm, 16mm and 24mm stripper and die puller sets)

General Add-Ons

- Radius Corner
- Special Angle Settings
- Small Diameter Round Tools**
 - Diameter 0.031(0.79) to 0.061(1.55) to punch, stripper, and die
 - Diameter 0.062(1.56) to 0.092(2.34) to punch, stripper, and die
- Narrow Width Shaped Tools**
 - Widths under 0.125(3.18) to punch, stripper, and die
- Maxima or Nitride**
 - MT 8mm, MT 16mm, MT 24mm to punch

STANDARD SHAPES (NUMBERING INDICATES SHAPE CODE):

